

**Application for a premises licence to be granted  
under the Licensing Act 2003**

**PLEASE READ THE FOLLOWING INSTRUCTIONS FIRST**

Before completing this form please read the guidance notes at the end of the form. If you are completing this form by hand please write legibly in block capitals. In all cases ensure that your answers are inside the boxes and written in black ink. Use additional sheets if necessary.

You may wish to keep a copy of the completed form for your records.

I/we MR. ASHES ASHATH  
(Insert name(s) of applicant)

apply for a premises licence under section 17 of the Licensing Act 2003 for the premises described in Part 1 below (the premises) and I/we are making this application to you as the relevant licensing authority in accordance with section 12 of the Licensing Act 2003

**Part 1 – Premises details**

Postal address of premises or, if none, ordnance survey map reference or description			
FAVORITE CHICKEN & RIBS 37 LONDON ROAD			
Post town	TOOTING.	Postcode	SW17 9JR

Telephone number at premises (if any)	0208 687 3130
Non-domestic rateable value of premises	£

**Part 2 - Applicant details**

Please state whether you are applying for a premises licence as      Please tick as appropriate

- a) an individual or individuals \*       please complete section (A)
- b) a person other than an individual \*
  - i as a limited company/limited liability partnership       please complete section (B)
  - ii as a partnership (other than limited liability)       please complete section (B)
  - iii as an unincorporated association or       please complete section (B)
  - iv other (for example a statutory corporation)       please complete section (B)
- c) a recognised club       please complete section (B)
- d) a charity       please complete section (B)

- e) the proprietor of an educational establishment  please complete section (B)
- f) a health service body  please complete section (B)
- g) a person who is registered under Part 2 of the Care Standards Act 2000 (c14) in respect of an independent hospital in Wales  please complete section (B)
- ga) a person who is registered under Chapter 2 of Part 1 of the Health and Social Care Act 2008 (within the meaning of that Part) in an independent hospital in England  please complete section (B)
- h) the chief officer of police of a police force in England and Wales  please complete section (B)

\* If you are applying as a person described in (a) or (b) please confirm (by ticking yes to one box below):

- I am carrying on or proposing to carry on a business which involves the use of the premises for licensable activities; or
- I am making the application pursuant to a
  - statutory function or
  - a function discharged by virtue of Her Majesty's prerogative

**(A) INDIVIDUAL APPLICANTS (fill in as applicable)**

Mr <input checked="" type="checkbox"/>	Mrs <input type="checkbox"/>	Miss <input type="checkbox"/>	Ms <input type="checkbox"/>	Other Title (for example, Rev)
Surname <b>ASHATH</b>		First names <b>ASES</b>		
Date of birth		I am 18 years old or over	<input checked="" type="checkbox"/>	Please tick yes
Nationality <b>BRITISH CITIZEN</b>				
Current residential address if different from premises address				
Post town		Postcode		
Daytime contact telephone number				
E-mail address (optional)				

**SECOND INDIVIDUAL APPLICANT (if applicable)**

Mr <input type="checkbox"/>	Mrs <input type="checkbox"/>	Miss <input type="checkbox"/>	Ms <input type="checkbox"/>	Other Title (for example, Rev)
Surname		First names		

<b>Date of birth</b>		I am 18 years old or over <input type="checkbox"/> Please tick yes	
<b>Nationality</b>			
Current residential address if different from premises address			
Post town		Postcode	
<b>Daytime contact telephone number</b>			
<b>E-mail address (optional)</b>			

**(B) OTHER APPLICANTS**

Please provide name and registered address of applicant in full. Where appropriate please give any registered number. In the case of a partnership or other joint venture (other than a body corporate), please give the name and address of each party concerned.

Name
Address
Registered number (where applicable)
Description of applicant (for example, partnership, company, unincorporated association etc.)
Telephone number (if any)
E-mail address (optional)

**Part 3 Operating Schedule**

When do you want the premises licence to start?

DD MM YYYY  

1	4	0	2	2	0	1	9
---	---	---	---	---	---	---	---

If you wish the licence to be valid only for a limited period, when do you want it to end?

DD	MM	YYYY

Please give a general description of the premises (please read guidance note 1)

THIS IS A FAST FOOD RESTAURANT WHICH SELLS HOT WARM FOOD. THIS IS SITUATED IN 37 LONDON ROAD, TOOTING, LONDON, SW17 9JR. THIS IS ON A3 LICENCE AND NOW APPLYING FOR LICENSABLE ACTIVITY OF A LATE NIGHT REFRESHMENT. <sup>PROVISION OF</sup>

If 5,000 or more people are expected to attend the premises at any one time, please state the number expected to attend.

What licensable activities do you intend to carry on from the premises?

(please see sections 1 and 14 and Schedules 1 and 2 to the Licensing Act 2003)

Provision of regulated entertainment (please read guidance note 2)

Please tick all that apply

- a) plays (if ticking yes, fill in box A)
- b) films (if ticking yes, fill in box B)
- c) indoor sporting events (if ticking yes, fill in box C)
- d) boxing or wrestling entertainment (if ticking yes, fill in box D)
- e) live music (if ticking yes, fill in box E)
- f) recorded music (if ticking yes, fill in box F)
- g) performances of dance (if ticking yes, fill in box G)
- h) anything of a similar description to that falling within (e), (f) or (g) (if ticking yes, fill in box H)

**Provision of late night refreshment** (if ticking yes, fill in box I)

Supply of alcohol (if ticking yes, fill in box J)

**In all cases complete boxes K, L and M**

**A**

<b>Plays</b> Standard days and timings (please read guidance note 7)			<b><u>Will the performance of a play take place indoors or outdoors or both – please tick</u></b> (please read guidance note 3)	Indoors	<input type="checkbox"/>
				Outdoors	<input type="checkbox"/>
				Both	<input type="checkbox"/>
<b>Day</b>	<b>Start</b>	<b>Finish</b>	<b><u>Please give further details here</u></b> (please read guidance note 4)		
Mon					
Tue					
Wed			<b><u>State any seasonal variations for performing plays</u></b> (please read guidance note 5)		
Thur					
Fri					
Sat			<b><u>Non standard timings. Where you intend to use the premises for the performance of plays at different times to those listed in the column on the left, please list</u></b> (please read guidance note 6)		
Sun					

**B**

<b>Films</b> Standard days and timings (please read guidance note 7)			<b><u>Will the exhibition of films take place indoors or outdoors or both – please tick</u></b> (please read guidance note 3)	Indoors	<input type="checkbox"/>			
				Outdoors	<input type="checkbox"/>			
				Both	<input type="checkbox"/>			
<b>Day</b>	<b>Start</b>	<b>Finish</b>	<b><u>Please give further details here</u></b> (please read guidance note 4)					
Mon								
Tue								
Wed						<b><u>State any seasonal variations for the exhibition of films</u></b> (please read guidance note 5)		
Thur								
Fri						<b><u>Non standard timings. Where you intend to use the premises for the exhibition of films at different times to those listed in the column on the left, please list</u></b> (please read guidance note 6)		
Sat								
Sun								

C

Indoor sporting events Standard days and timings (please read guidance note 7)			<b><u>Please give further details</u></b> (please read guidance note 4)
Day	Start	Finish	
Mon			
Tue			<b><u>State any seasonal variations for indoor sporting events</u></b> (please read guidance note 5)
Wed			
Thur			<b><u>Non standard timings. Where you intend to use the premises for indoor sporting events at different times to those listed in the column on the left, please list</u></b> (please read guidance note 6)
Fri			
Sat			
Sun			



**D**

<b>Boxing or wrestling entertainments</b> Standard days and timings (please read guidance note 7)			<b><u>Will the boxing or wrestling entertainment take place indoors or outdoors or both – please tick</u></b> (please read guidance note 3)	Indoors	<input type="checkbox"/>
				Outdoors	<input type="checkbox"/>
				Both	<input type="checkbox"/>
<b>Day</b>	<b>Start</b>	<b>Finish</b>	<b><u>Please give further details here</u></b> (please read guidance note 4)		
Mon					
Tue			<b><u>State any seasonal variations for boxing or wrestling entertainment</u></b> (please read guidance note 5)		
Wed					
Thur			<b><u>Non standard timings. Where you intend to use the premises for boxing or wrestling entertainment at different times to those listed in the column on the left, please list</u></b> (please read guidance note 6)		
Fri					
Sat					
Sun					

**E**

<b>Live music</b> Standard days and timings (please read guidance note 7)			<b>Will the performance of live music take place indoors or outdoors or both – please tick</b> (please read guidance note 3)	Indoors	<input type="checkbox"/>
				Outdoors	<input type="checkbox"/>
				Both	<input type="checkbox"/>
<b>Day</b>	<b>Start</b>	<b>Finish</b>	<b>Please give further details here</b> (please read guidance note 4)		
Mon					
Tue					
<b>Wed</b>			<b>State any seasonal variations for the performance of live music</b> (please read guidance note 5)		
Thur					
Fri					
<b>Sat</b>			<b>Non standard timings. Where you intend to use the premises for the performance of live music at different times to those listed in the column on the left, please list</b> (please read guidance note 6)		
Sun					

**F**

<b>Recorded music</b> Standard days and timings (please read guidance note 7)			<b>Will the playing of recorded music take place indoors or outdoors or both – please tick</b> (please read guidance note 3)	Indoors	<input type="checkbox"/>
Day	Start	Finish		Outdoors	<input type="checkbox"/>
Mon			<b>Please give further details here</b> (please read guidance note 4)	Both	<input type="checkbox"/>
Tue					
Wed			<b>State any seasonal variations for the playing of recorded music</b> (please read guidance note 5)		
Thur					
Fri			<b>Non standard timings. Where you intend to use the premises for the playing of recorded music at different times to those listed in the column on the left, please list</b> (please read guidance note 6)		
Sat					
Sun					

**G**

<b>Performances of dance</b> Standard days and timings (please read guidance note 7)			<b><u>Will the performance of dance take place indoors or outdoors or both – please tick</u></b> (please read guidance note 3)	Indoors	<input type="checkbox"/>
				Outdoors	<input type="checkbox"/>
				Both	<input type="checkbox"/>
<b>Day</b>	<b>Start</b>	<b>Finish</b>	<b><u>Please give further details here</u></b> (please read guidance note 4)		
Mon					
Tue					
Wed			<b><u>State any seasonal variations for the performance of dance</u></b> (please read guidance note 5)		
Thur					
Fri					
Sat			<b><u>Non standard timings. Where you intend to use the premises for the performance of dance at different times to those listed in the column on the left, please list</u></b> (please read guidance note 6)		
Sun					

**H**

<p><b>Anything of a similar description to that falling within (e), (f) or (g)</b> Standard days and timings (please read guidance note 7)</p>			<p>Please give a description of the type of entertainment you will be providing</p>		
<b>Day</b>	<b>Start</b>	<b>Finish</b>	<p><b><u>Will this entertainment take place indoors or outdoors or both – please tick</u></b> (please read guidance note 3)</p>	Indoors	<input type="checkbox"/>
Mon				Outdoors	<input type="checkbox"/>
				Both	<input type="checkbox"/>
Tue			<p><b><u>Please give further details here</u></b> (please read guidance note 4)</p>		
Wed					
Thur			<p><b><u>State any seasonal variations for entertainment of a similar description to that falling within (e), (f) or (g)</u></b> (please read guidance note 5)</p>		
Fri					
Sat			<p><b><u>Non standard timings. Where you intend to use the premises for the entertainment of a similar description to that falling within (e), (f) or (g) at different times to those listed in the column on the left, please list</u></b> (please read guidance note 6)</p>		
Sun					

I

Late night refreshment Standard days and timings (please read guidance note 7)			Will the provision of late night refreshment take place indoors or outdoors or both – please tick (please read guidance note 3)	Indoors	<input checked="" type="checkbox"/>
Day	Start	Finish		Outdoors	<input type="checkbox"/>
Mon	11.00hrs		Please give further details here (please read guidance note 4)  FOOD WILL BE SERVED OVER THE COUNTER INDOORS & FOR TAKEAWAY.	Both	<input type="checkbox"/>
		02.00hrs			
Tue	11.00hrs		State any seasonal variations for the provision of late night refreshment (please read guidance note 5)		
		02.00hrs			
Wed	11.00hrs		Non standard timings. Where you intend to use the premises for the provision of late night refreshment at different times, to those listed in the column on the left, please list (please read guidance note 6)		
		02.00hrs			
Thur	11.00hrs				
		02.00hrs			
Fri	11.00hrs				
		02.00hrs			
Sat	11.00hrs				
		02.00hrs			
Sun	11.00hrs				
		02.00hrs			

**J**

<b>Supply of alcohol</b> Standard days and timings (please read guidance note 7)			<b>Will the supply of alcohol be for consumption – please tick</b> (please read guidance note 8)	On the premises	<input type="checkbox"/>
				Off the premises	<input type="checkbox"/>
				Both	<input type="checkbox"/>
<b>Day</b>	<b>Start</b>	<b>Finish</b>	<b>State any seasonal variations for the supply of alcohol</b> (please read guidance note 5)		
Mon					
Tue					
Wed					
Thur					
Fri					
Sat					
			<b>Non standard timings. Where you intend to use the premises for the supply of alcohol at different times to those listed in the column on the left, please list</b> (please read guidance note 6)		
Sun					

**State the name and details of the individual whom you wish to specify on the licence as designated premises supervisor (Please see declaration about the entitlement to work in the checklist at the end of the form):**

Name	
Date of birth	
Address	
Postcode	
Personal licence number (if known)	
Issuing licensing authority (if known)	

□□□□

K

Please highlight any adult entertainment or services, activities, other entertainment or matters ancillary to the use of the premises that may give rise to concern in respect of children (please read guidance note 9).

FAST FOOD SUPPLY OVER THE  
COUNTER INDOORS. & TAKE AWAY.

L

Hours premises are open to the public Standard days and timings (please read guidance note 7)			State any seasonal variations (please read guidance note 5)
Day	Start	Finish	
Mon	11.00 hrs	02.00 hrs	
Tue	11.00 hrs	02.00 hrs	
Wed	11.00 hrs	02.00 hrs	
Thur	11.00 hrs	02.00 hrs	<b>Non standard timings. Where you intend the premises to be open to the public at different times from those listed in the column on the left, please list</b> (please read guidance note 6)
Fri	11.00 hrs	02.00 hrs	
Sat	11.00 hrs	02.00 hrs	
Sun	11.00 hrs	02.00 hrs	



**M** Describe the steps you intend to take to promote the four licensing objectives:

**a) General – all four licensing objectives (b, c, d and e) (please read guidance note 10)**

ALL OUR STAFF ARE AWARE OF THE LAW RELATING TO SALE OF HOT FOOD & DRINK BETWEEN 11.00PM AND 5.00AM. MANAGEMENT WILL TAKE EVERY STEPS TO ENSURE THAT IN AND AROUND THE PREMISES TO BE OF TROUBLE FREE AND ALSO CONCERNED OF PREVENTION OF CRIME AND DISORDER, PUBLIC SAFETY, PUBLIC NUISANCE AND PROTECTION OF CHILDREN FROM HARM.

**b) The prevention of crime and disorder**

CCTV SYSTEM CONSISTING OF 9 CAMERAS IS IN PLACE OF WHICH 2 CAMERAS HAVE BEEN FIXED EXTERNALLY FACING LONDON ROAD TO THE LEFT AND RIGHT. REST OF CCTV ARE INSIDE SHOP TO MONITOR DAILY ACTIVITIES. RECORDINGS WILL BE KEPT IN ACCORDANCE WITH THE GUIDELINES FOR A MINIMUM OF 31 DAYS AND WILL BE MADE AVAILABLE TO ALL RELEVANT AUTHORITIES ON REQUEST. ALARM SYSTEM AND EMERGENCY LIGHTS ARE IN PLACE AT THE SHOP. THE SHOP HAS BEEN FIXED WITH EXTERNAL METAL SHUTTER WITH HEAVY DUTY PROFESSIONAL LOCKS.

**c) Public safety**

OUR STAFF HAVE BEEN TRAINED TO DEAL WITH ANY OUTBREAK OF FIRE AT THE PREMISES. 3 FIRE EXTINGUISHERS ARE IN THE PREMISES AND REGULARLY SERVICED IN LINE WITH GUIDELINES OF FIRE AUTHORITY. SMOKE DETECTORS AND FIRE ALARM IS AVAILABLE AT THE PREMISES. THE MANAGEMENT WILL ENSURE TO TAKE EVERY STEPS TO MAINTAIN PUBLIC SAFETY AT ALL TIMES. TIME TO TIME RISK ASSESSMENT WILL BE TAKEN IN AND AROUND THE PREMISES AND IMPLEMENT NECESSARY STEPS TO MAINTAIN PUBLIC SAFETY AT ALL TIMES. SHOP IS WELL LIT AND VENTILATED ALWAYS.

**d) The prevention of public nuisance**

THE AREA IN AND AROUND THE PREMISES WILL BE KEPT CLEAN AND TIDY ALWAYS. ALL REFUSES ARE DISPOSED ACCORDING TO LOCAL REFUSE COLLECTION SYSTEM IN PLACE. THE SHOP IS HAVING REFUSE COLLECTION CONTRACT. THE MANAGEMENT WILL CLOSELY MONITOR IN AND AROUND THE PREMISES TO ENSURE THAT THE AREA IS SAFER FOR THE PUBLIC.

**e) The protection of children from harm**

MANAGEMENT WILL ALWAYS TAKE DUE CARE FOR THE PROTECTION OF CHILDREN FROM HARM. OUR BUSINESS IS A FAST FOOD RESTAURANT NOT DEALING WITH ANY SALE OF ALCOHOL. HOWEVER, UTMOST CARE WILL BE TAKEN BETWEEN 11.00PM AND 02.00AM IN PROTECTING CHILDREN FROM HARM.

**Checklist:**

Please tick to indicate agreement

- I have made or enclosed payment of the fee.
- I have enclosed the plan of the premises.
- I have sent copies of this application and the plan to responsible authorities and others where applicable.
- I have enclosed the consent form completed by the individual I wish to be designated premises supervisor, if applicable.
- I understand that I must now advertise my application.
- I understand that if I do not comply with the above requirements my application will be rejected.
- [Applicable to all individual applicants, including those in a partnership which is not a limited liability partnership, but not companies or limited liability partnerships] I have included documents demonstrating my entitlement to work in the United Kingdom (please read note 15).

**IT IS AN OFFENCE, UNDER SECTION 158 OF THE LICENSING ACT 2003, TO MAKE A FALSE STATEMENT IN OR IN CONNECTION WITH THIS APPLICATION. THOSE WHO MAKE A FALSE STATEMENT MAY BE LIABLE ON SUMMARY CONVICTION TO A FINE OF ANY AMOUNT.**

**IT IS AN OFFENCE UNDER SECTION 24B OF THE IMMIGRATION ACT 1971 FOR A PERSON TO WORK WHEN THEY KNOW, OR HAVE REASONABLE CAUSE TO BELIEVE, THAT THEY ARE DISQUALIFIED FROM DOING SO BY REASON OF THEIR IMMIGRATION STATUS. THOSE WHO EMPLOY AN ADULT WITHOUT LEAVE OR WHO IS SUBJECT TO CONDITIONS AS TO EMPLOYMENT WILL BE LIABLE TO A CIVIL PENALTY UNDER SECTION 15 OF THE IMMIGRATION, ASYLUM AND NATIONALITY ACT 2006 AND PURSUANT TO SECTION 21 OF THE SAME ACT, WILL BE COMMITTING AN OFFENCE WHERE THEY DO SO IN THE KNOWLEDGE, OR WITH REASONABLE CAUSE TO BELIEVE, THAT THE EMPLOYEE IS DISQUALIFIED.**

**Part 4 – Signatures** (please read guidance note 11)

**Signature of applicant or applicant’s solicitor or other duly authorised agent** (see guidance note 12). **If signing on behalf of the applicant, please state in what capacity.**

<b>Declaration</b>	<ul style="list-style-type: none"> <li>• [Applicable to individual applicants only, including those in a partnership which is not a limited liability partnership] I understand I am not entitled to be issued with a licence if I do not have the entitlement to live and work in the UK (or if I am subject to a condition preventing me from doing work relating to the carrying on of a licensable activity) and that my licence will become invalid if I cease to be entitled to live and work in the UK (please read guidance note 15).</li> <li>• The DPS named in this application form is entitled to work in the UK (and is not subject to conditions preventing him or her from doing work relating to a licensable activity) and I have seen a copy of his or her proof of entitlement to work, if appropriate (please see note 15)</li> </ul>
Signature	
Date	14/01/2019
Capacity	APPLICANT

**For joint applications, signature of 2<sup>nd</sup> applicant or 2<sup>nd</sup> applicant's solicitor or other authorised agent (please read guidance note 13). If signing on behalf of the applicant, please state in what capacity.**

Signature	
Date	
Capacity	

Contact name (where not previously given) and postal address for correspondence associated with this application (please read guidance note 14)			
Post town		Postcode	
Telephone number (if any)			
If you would prefer us to correspond with you by e-mail, your e-mail address (optional)			

**Notes for Guidance**

1. Describe the premises, for example the type of premises, its general situation and layout and any other information which could be relevant to the licensing objectives. Where your application includes off-supplies of alcohol and you intend to provide a place for consumption of these off-supplies, you must include a description of where the place will be and its proximity to the premises.
2. In terms of specific regulated entertainments please note that:

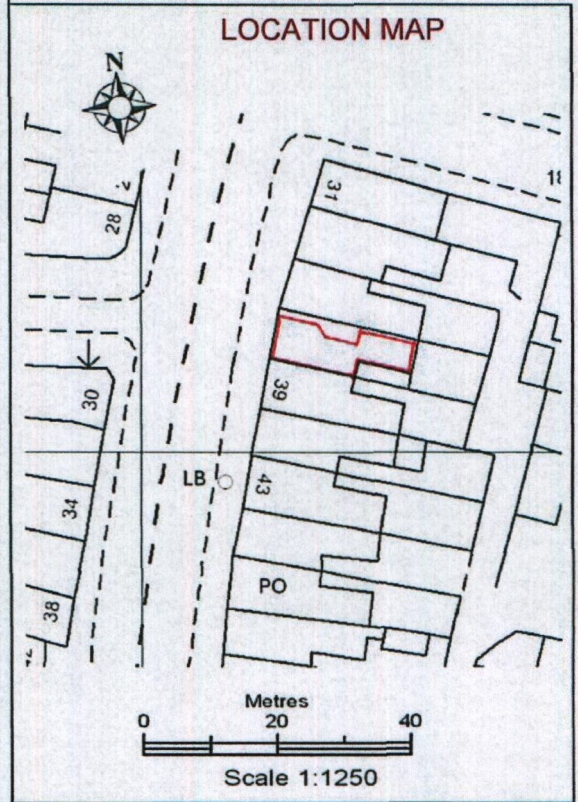
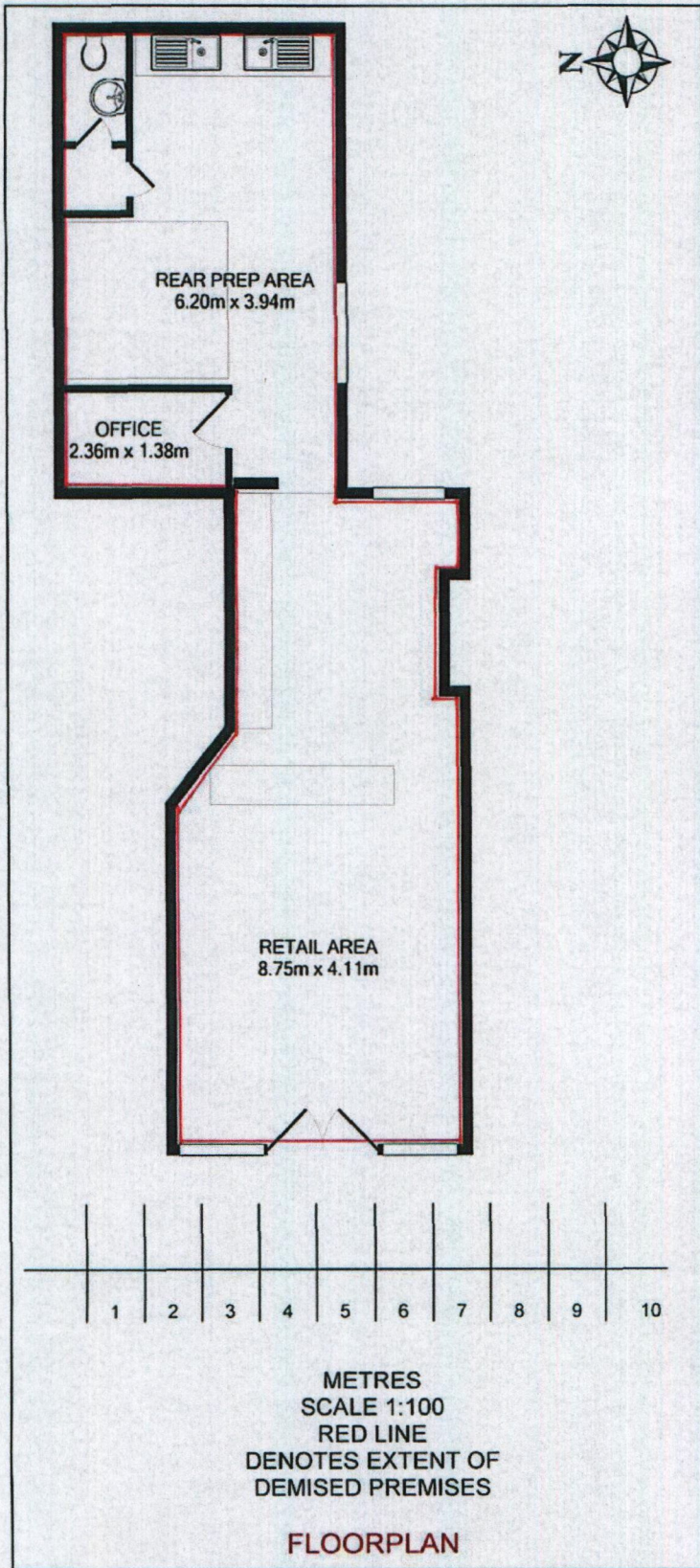

**LEASE PLAN**

**GROUND FLOOR 37 LONDON ROAD  
TOOTING LONDON SW17 9JR**

16TH SEPTEMBER 2010  
DRAWING ID 14091001

© james stevens group  
Park House 206 -208 Latimer Road London  
W10 6QY 020 8968 1131 www.groupjs.net